

# Amphenol® 67 and 165 Series Miniaturized Standard Connectors

12-023-6



---

**Amphenol**

---

| <b>Table of Contents</b>  | <b>Page No.</b> |
|---|-----------------|
| Amphenol® 67 Series “Minni E”   |                 |
| General Information, Design Characteristics, Customer Options . . . . . | 1               |
| Connector Applications, Mounting Dimensions . . . . .                   | 2, 3            |
| Insert Arrangements . . . . .   | 4               |
| How to Order . . . . .  | 5               |
| Amphenol® 165 Series - Miniaturized MIL-C-5015                          |                 |
| General Information, Design Characteristics, Customer Options . . . . . | 6               |
| Connector Applications . . . . .  | 7               |
| Insert Arrangements, Ordering Information . . . . .                     | 8               |
| Sales Office Listing  |                 |

# Amphenol® 67 Series “Minni E” environmental resistant cylindrical connectors

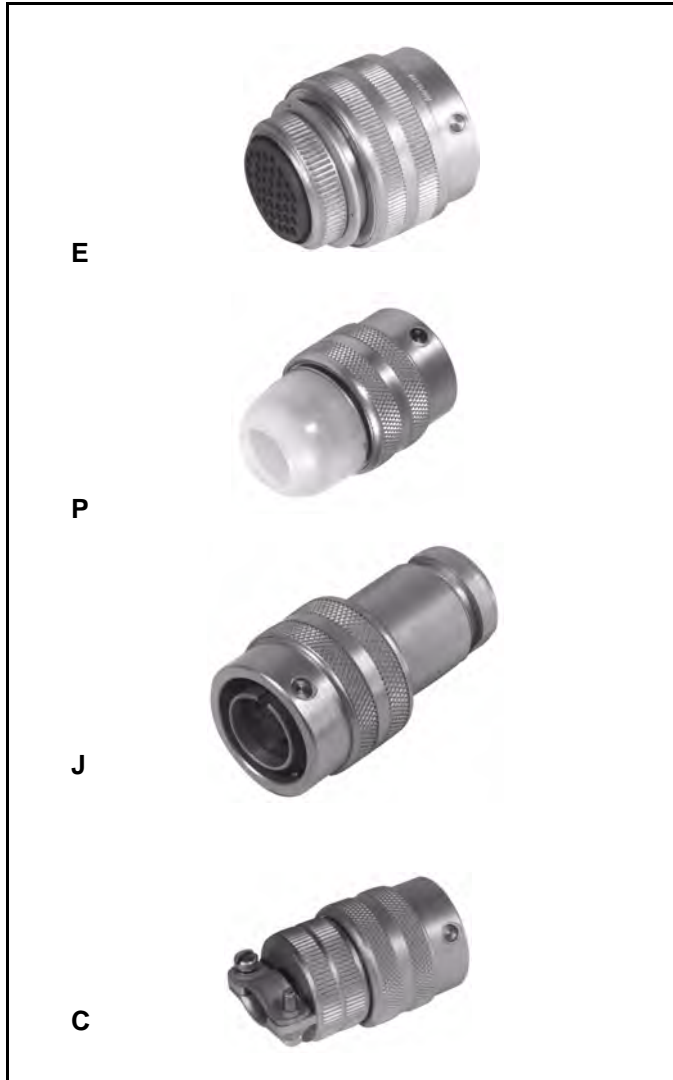

## DESIGN CHARACTERISTICS

- Approximately half the weight of standard cylindricals
- Quick, positive, stainless steel bayonet coupling
- Operating temperatures from -67°F to +257°F per MIL-C-5015
- Sealed connectors capable of 1500 VRMS at 70,000 ft. altitude
- Vibration resistance of 10 to 2,000 cps at 20Gs
- Interfacial seal of neoprene rubber with individual contact barriers
- Moisture resistance exceeds MIL-C-5015 requirements with potting
- UL approved recognition file E115497

## CUSTOMER OPTIONS

- Five shell styles
- Choice of unitized back end grommet or provision for potting
- Seventeen insert configurations
- Four construction classes available:
  - E - with unitized grommet for individual wire seal
  - P - includes potting mold
  - J - sealing clamp for jacketed cable
  - C - vise action with two-screw strain relief

Shell components are fabricated from high grade aluminum with gray anodize finish and stainless steel bayonet pins and slots. Contacts are copper alloy gold over nickel plate. Inserts are diallyl phthalate, providing high arc and insulation resistance under both humidity and thermal stress conditions. Positive locking action is provided by the spring-loaded coupling ring.

Amphenol® 67 Series connectors are ideal for applications that require a light to medium weight, durable, environmentally sealed connector.

For additional information on Amphenol® 67 Series connectors, or for special application requirements, contact your local sales office, authorized distributor, or

Amphenol Corporation  
Amphenol Aerospace  
40-60 Delaware Avenue  
Sidney, New York 13838-1395  
Phone: 607-563-5011  
Fax: 607-563-5157  
www.amphenol-aerospace.com

## Voltage Rating

|                       | Rating** | Mechanical Spacing (Nominal) | Flashover V-RMS* | Test V-RMS* | Recommended Working Voltage |     |
|-----------------------|----------|------------------------------|------------------|-------------|-----------------------------|-----|
|                       |          |                              |                  |             | DC                          | AC  |
| Sea Level (unsealed)  | A        | .034                         | 2,000            | 1,500       | 700                         | 500 |
|                       | B        | .046                         | 2,300            | 1,800       | 840                         | 600 |
| Sea Level (sealed)    | A        | .034                         | 2,500            | 2,000       | 700                         | 500 |
|                       | B        | .046                         | 3,000            | 2,500       | 840                         | 600 |
| 70,000 ft. (unsealed) | A        | .034                         | 500              | 375         | 175                         | 125 |
|                       | B        | .046                         | 600              | 450         | 210                         | 150 |
| 70,000 ft. (sealed)   | A        | .034                         | 2,500            | 1,500       | 700                         | 500 |
|                       | B        | .046                         | 3,000            | 1,800       | 840                         | 600 |

\* RATING - "B" rating is for insert 14-5 which takes a higher voltage; "A" rating is for other inserts.

\*\* TYPICAL FLASHOVER VOLTAGES AT STANDARD CONDITIONS  
(unsealed) Refers to connectors with no provisions for sealing front or rear areas.  
(sealed) Refers to connectors that are potted or pressurized in mounting, with front and rear areas sealed.

**Amphenol Aerospace is a certified ISO 9001 manufacturer.**

# 67 Series

## connector applications



### Mounting Dimensions

(For all 67 Series square flange connectors)

| Connector Size | A     | B     | Suggested Mounting Hole |
|----------------|-------|-------|-------------------------|
| 12             | .812  | 1.031 | .700                    |
| 14             | .906  | 1.125 | .822                    |
| 18             | 1.062 | 1.312 | 1.072                   |
| 20             | 1.156 | 1.437 | 1.197                   |
| 22             | 1.250 | 1.562 | 1.291                   |

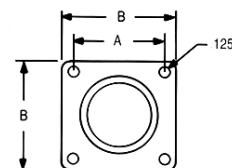

NOTE: All dimensions for reference only.

# 67 Series connector applications

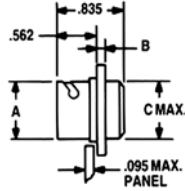

67-02E

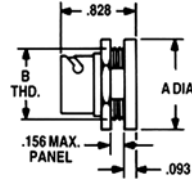

67-03E

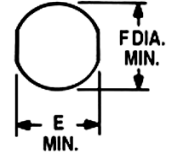

Suggested  
Mounting Hole

| Connector Size | A     | B    | C     |
|----------------|-------|------|-------|
| 12             | .662  | .062 | .690  |
| 14             | .781  | .062 | .812  |
| 18             | 1.032 | .093 | 1.062 |
| 20             | 1.156 | .093 | 1.187 |
| 22             | 1.281 | .093 | 1.281 |

| Connector Size | A     | B     | E     | F     |
|----------------|-------|-------|-------|-------|
| 12             | 1.031 | .750  | .695  | .755  |
| 14             | 1.156 | .875  | .820  | .880  |
| 18             | 1.406 | 1.125 | 1.079 | 1.130 |
| 20             | 1.531 | 1.250 | 1.195 | 1.255 |
| 22             | 1.656 | 1.375 | 1.320 | 1.380 |

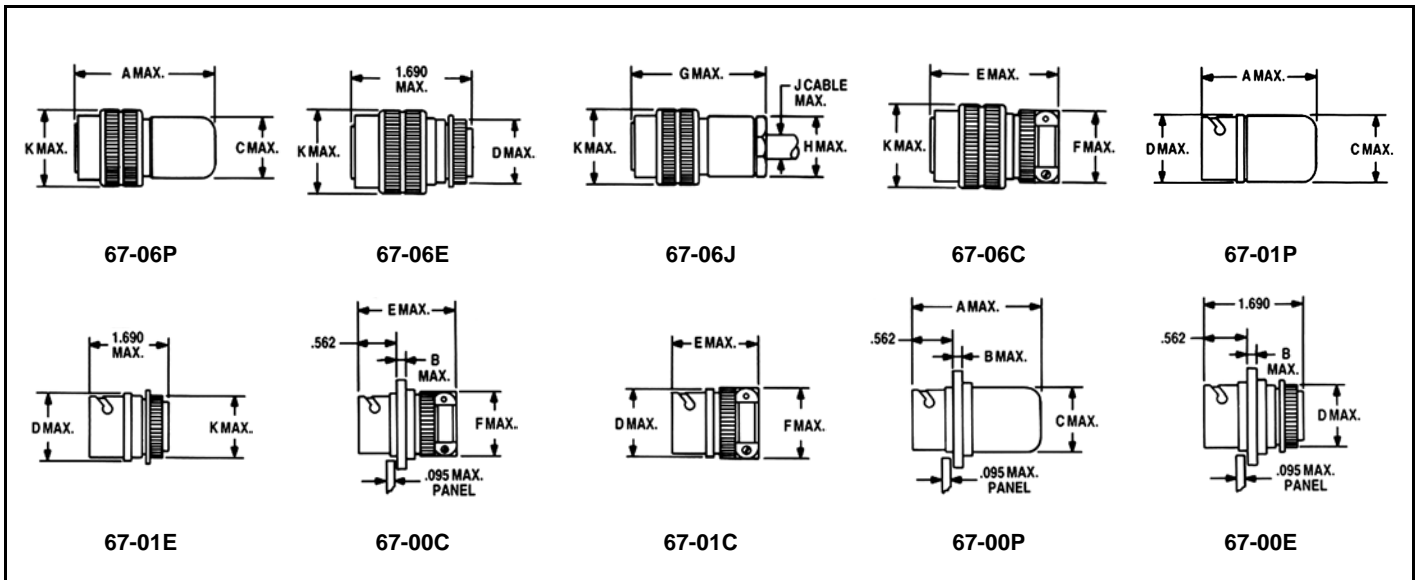

| Connector Size | A     | B    | C     | D     | E     | F     | G     | H     | J    | K     |
|----------------|-------|------|-------|-------|-------|-------|-------|-------|------|-------|
| 12             | 1.687 | .093 | .795  | .895  | 1.870 | .817  | 1.937 | .706  | .250 | .957  |
| 14             | 1.687 | .093 | .920  | 1.000 | 1.870 | .967  | 1.937 | .812  | .375 | 1.082 |
| 18             | 1.687 | .093 | 1.170 | 1.250 | 1.870 | 1.185 | 1.937 | 1.062 | .656 | 1.375 |
| 20             | 1.734 | .093 | 1.223 | 1.375 | 1.970 | 1.312 | 2.312 | 1.187 | .750 | 1.500 |
| 22             | 1.734 | .093 | 1.352 | 1.468 | 1.970 | 1.440 | 2.312 | 1.317 | .875 | 1.625 |

NOTE: All dimensions for reference only.

# 67 Series

## insert arrangements

front face of insert illustrated

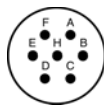

12-7

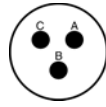

12-60

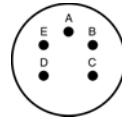

14-5

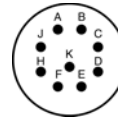

14-9

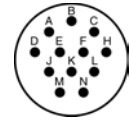

14-12

Insert Arrangement  
Number of Contacts  
Contact Size

7  
20

3  
16

5  
20

9  
20

12  
20

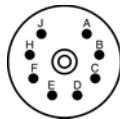

14-61

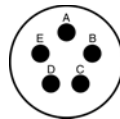

14-63

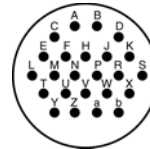

18-24

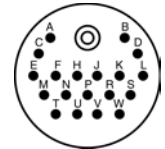

18-62

Insert Arrangement  
Number of Contacts  
Contact Size

8  
20

5  
16

24  
20

19  
20

plus 1 shielded contact

plus 1 shielded contact

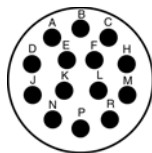

18-64

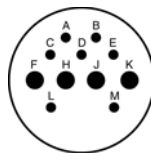

18-65

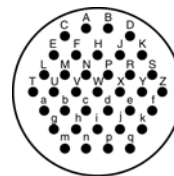

20-37

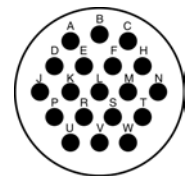

20-66

Insert Arrangement  
Number of Contacts  
Contact Size

14  
16

7 4  
20 16

37  
20

19  
16

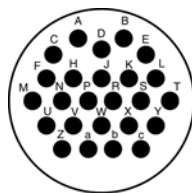

22-67

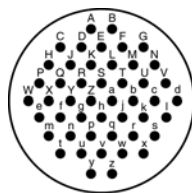

22-48

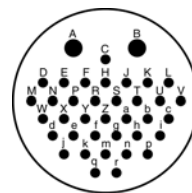

22-68

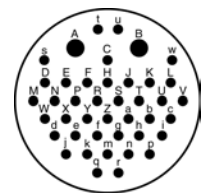

22-69

Insert Arrangement  
Number of Contacts  
Contact Size

25  
16

48  
20

36 2  
20 16

40 2  
20 16

Current rating - #20 contact: 7.5 amps, #16 contact: 12 amps  
Shielded contact: 7.5 amps

Contact Legend

16 ●

20 ●

shielded ☉

# 67 Series

## how to order

Amphenol® 67 Series “Minni E” Connectors can be ordered by coded part number. Ordering procedure is illustrated by part number 67-06E12-7PW-100 as shown below:

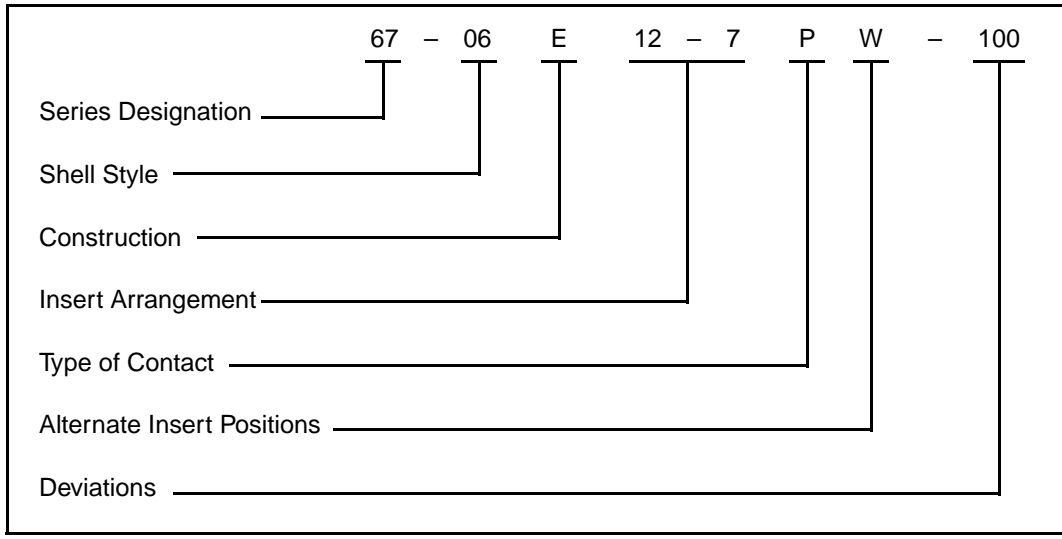

### Series Designation

67 -

### Shell Style

- 00 - Wall mounting receptacle
- 01 - Cable mounting receptacle
- 02 - Panel mount receptacle
- 03 - Rear panel mount, round flange receptacle
- 06 - Cable plug - straight

### Construction

- E** Environmentally sealed (Unitized grommet)
- P** Environmentally sealed (Disposable polyethylene potting form furnished)
- J** Sealing clamp for jacketed cable (Waterproof)
- C** Mechanical Clamp (Sealed only when potted)

### Insert Arrangement

See available insert arrangements, page 4

### Type of Contact

- P - Pin
- S - Socket

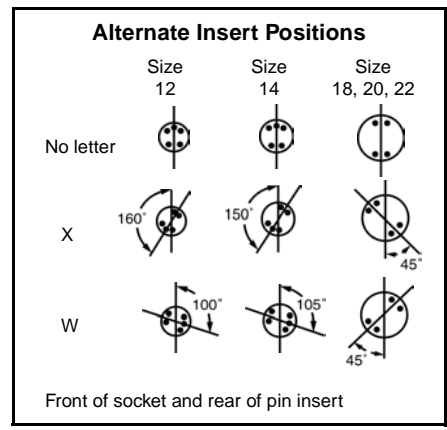

### Deviations

- 100 - 100 μin. gold over silver contacts
- 106 - Pretinned solder wells
- 113 - Aluminum parts iridite finish

# Amphenol® 165 Series

## miniaturized standard connectors

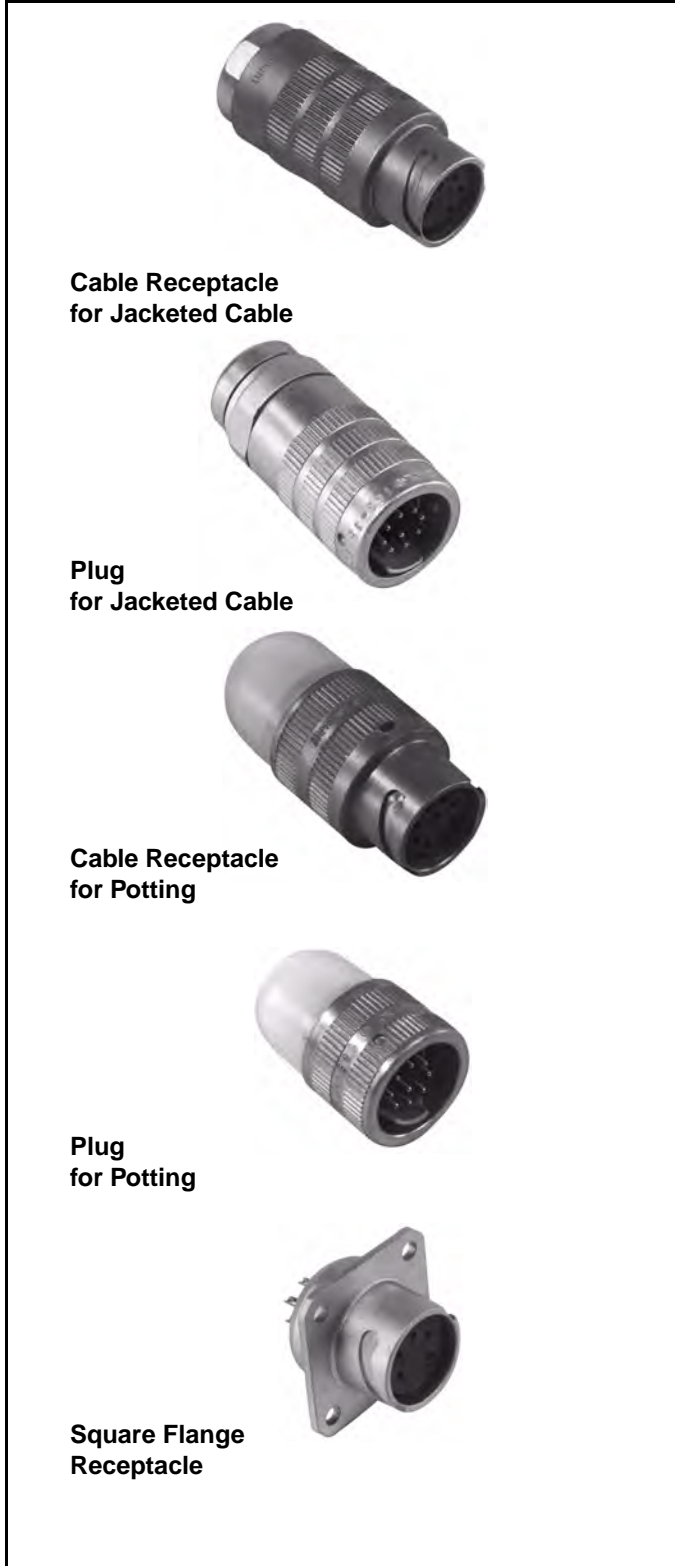

### DESIGN CHARACTERISTICS

- Approximately one-third the size and weight of standard MIL-C-5015 connectors
- Quick, positive, bayonet coupling
- O-ring seals in both plugs and receptacles make connectors pressure proof and water protected when mated
- Meets pressure seal requirements of MIL-C-5015, Class C construction
- UL approved recognition file E115497

### CUSTOMER OPTIONS

- Five shell styles in two sizes - large and small
- Seven insert configurations

Shell components are fabricated from high grade aluminum with gray anodize finish. Contacts are copper alloy gold over nickel plate. Inserts are diallyl phthalate, providing high arc and insulation resistance under both humidity and thermal stress conditions. Connectors using female inserts feature a sandwich construction with the insert spun into a cartridge. Connectors are factory sealed to prevent leakage.

Amphenol® 165 Series connectors are ideal for applications that demand a lightweight connector that meets MIL-C-5015 requirements.

For additional information on Amphenol® 165 Series connectors, or for special application requirements, contact your local sales office, authorized distributor, or

Amphenol Corporation  
 Amphenol Aerospace  
 40-60 Delaware Avenue  
 Sidney, New York 13838-1395  
 Phone: 607-563-5011  
 Fax: 607-563-5157

### Connector Weights

| Style                        | Weight (pounds) |        |
|------------------------------|-----------------|--------|
|                              | Small           | Large  |
| Cable receptacle for potting | 0.0415          | 0.0599 |
| Cable receptacle             | 0.0600          | 0.0945 |
| Panel receptacle             | 0.0264          | 0.0439 |
| Plug                         | 0.0659          | 0.0975 |
| Plug for potting             | 0.0302          | 0.0490 |

Amphenol Aerospace is a certified ISO 9001 manufacturer.



# 165 Series connector applications

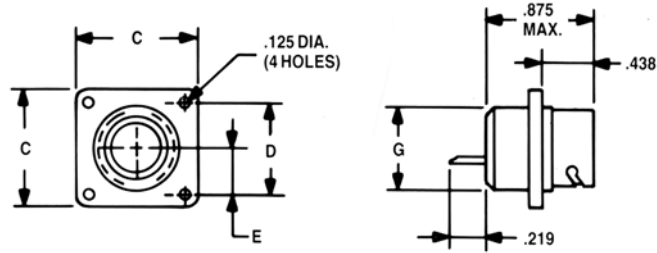

**Panel Receptacle**

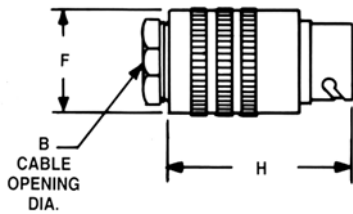

**Cable Receptacle**

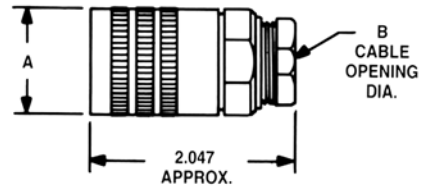

**Cable Plug**

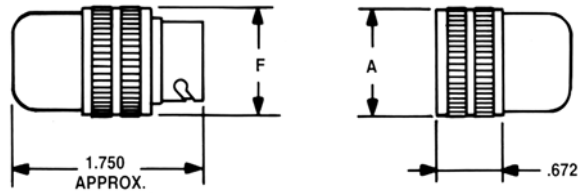

**Potting Construction**

|       | A     | B     | C     | D    | E    | F     | G     | H     |
|-------|-------|-------|-------|------|------|-------|-------|-------|
| Small | .891  | .375* | 1.063 | .781 | .391 | .875  | .813  | 1.922 |
| Large | 1.141 | .656  | 1.313 | .969 | .484 | 1.125 | 1.063 | 1.938 |

\* 165-33 and 165-34 have cable opening of .281

NOTE: All dimensions for reference only

# 165 Series

## insert arrangements, order information

front face of insert illustrated

The following chart provides ordering information. For example, to order a 165 Series plug with pin contacts use part number 165-33.

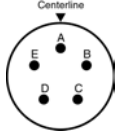
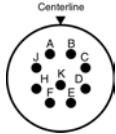
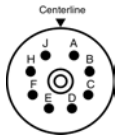
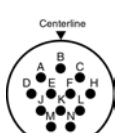
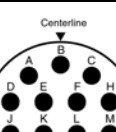
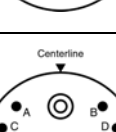
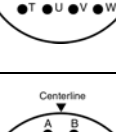
| Insert Arrangements   | Insert Style | Plug        | Receptacle Sq. Flange | Cable Receptacle | Potting Constructions |             |
|---|--------------|-------------|-----------------------|------------------|-----------------------|-------------|
|   |              |             |                       |                  | Plug                  | Receptacle  |
|  <p>5 #20 contacts<br/>Current Rating (Amperes) 7.5</p> <p>Voltage rating (Volts RMS at sea level) 600</p>                             | Pin          | 165-33      | 165-35                | 165-35-1002      | 165-33-1000           | 165-35-1000 |
|   | Socket       | 165-34      | 165-36                | 165-36-1003      | 165-34-1000           | 165-36-1000 |
|  <p>9 #20 contacts<br/>Current Rating (Amperes) 7.5</p> <p>Voltage rating (Volts RMS at sea level) 500</p>                             | Pin          | 165-13      | 165-15                | 165-15-1002      | 165-13-1000           | 165-15-1000 |
|   | Socket       | 165-14      | 165-16                | 165-16-1003      | 165-14-1000           | 165-16-1000 |
|  <p>8 #20 contacts,<br/>1 Shielded contact<br/>Current Rating (Amperes) 10.0</p> <p>Voltage rating (Volts RMS at sea level) 500</p>   | Pin          | 165-82      | 165-73                | 165-73-1001      | 165-82-1000           | 165-73-1000 |
|   | Socket       | 165-61-1008 | 165-83                | 165-83-1001      | 165-61                | 165-83-1000 |
|  <p>12 #20 contacts<br/>Current Rating (Amperes) 7.5</p> <p>Voltage rating (Volts RMS at sea level) 500</p>                          | Pin          | 165-9       | 165-11                | 165-11-1002      | 165-9-1000            | 165-11-1000 |
|   | Socket       | 165-10      | 165-12                | 165-12-1002      | 165-10-1000           | 165-12-1000 |
|  <p>14 #16 contacts<br/>Current Rating (Amperes) 17.0</p> <p>Voltage rating (Volts RMS at sea level) 500</p>                         | Pin          | 165-29      | 165-31                | 165-31-1003      | 165-29-1000           | 165-31-1000 |
|   | Socket       | 165-30      | 165-32                | 165-32-1006      | 165-30-1000           | 165-32-1000 |
|  <p>19 #20 contacts,<br/>1 Shielded contact<br/>Current Rating (Amperes) 10.0</p> <p>Voltage rating (Volts RMS at sea level) 500</p> | Pin          | 165-86      | 165-84                | 165-84-1001      | 165-86-1000           | 165-84-1000 |
|   | Socket       | 165-62-1007 | 165-85                | 165-85-1001      | 165-62                | 165-85-1000 |
|  <p>24 #20 contacts<br/>Current Rating (Amperes) 7.5</p> <p>Voltage rating (Volts RMS at sea level) 500</p>                          | Pin          | 165-25      | 165-27                | 165-27-1005      | 165-25-1000           | 165-27-1000 |
|   | Socket       | 165-26      | 165-28                | 165-28-1003      | 165-26-1000           | 165-28-1000 |