

OUTER PIN CONTACT:
.218±.001 DIA

INTERMEDIATE SOCKET CONTACT:
MATES WITH A
.074±.001 DIA PIN

INNER PIN CONTACT:
.0240±.0005 DIA

REVISIONS				
ZONE	LTR	DESCRIPTION	DATE	APPROVED
	A	INITIAL RELEASE NUM: 70091-203		
	B	(CL II) SEE CH6 SHEET ECN: 80174	8-12-96 groedel	
	C	(CL II) UPDATED: 9-4796-1 TO -2/ BENDIX TO AMPHENOL ECN: B1418	4-12-11 JONES	

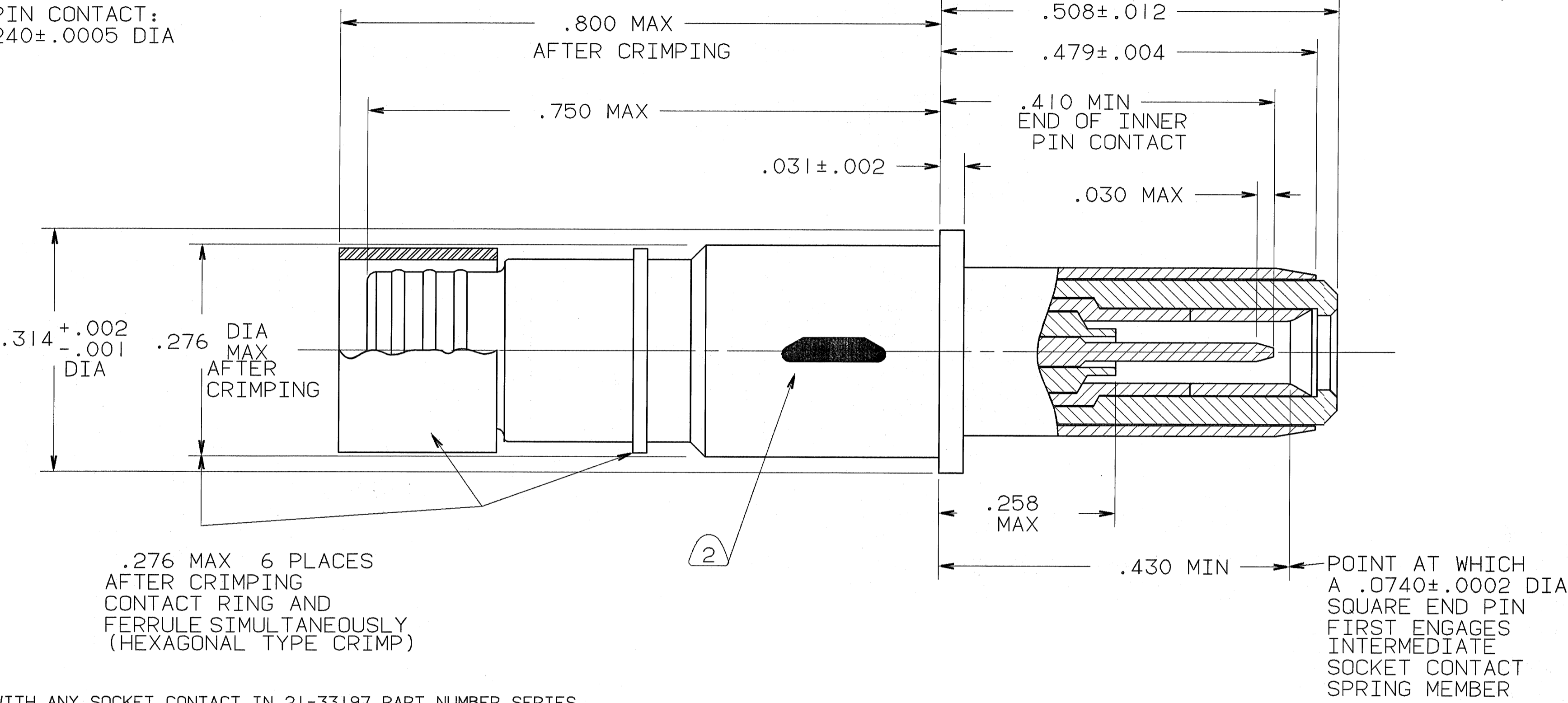

8. MATES WITH ANY SOCKET CONTACT IN 21-33197 PART NUMBER SERIES.
7. HANDLE CAREFULLY TO AVOID DISTORTION.
6. FINISH ON ALL METAL PARTS:
.000050 MIN GOLD. (KNOOP HARDNESS 130-200). OVER NICKEL UNDERPLATE.
5. INDICATED ITEM IS NOT ILLUSTRATED.
4. CONTACT WILL ACCOMMODATE TRIAXIAL CABLE MCAIR PART NUMBER ST5M1323-001, REV J.
3. DRAWING ILLUSTRATES FINAL ASSEMBLY. COMPLETE INSTALLATION INSTRUCTIONS, (F/N 8), ARE PACKED WITH EACH ASSEMBLY. PACKAGE PER PRODUCTION PROCESS SHEET.
2. IF NOT PREVIOUSLY STAMPED, BLACK INK STAMP TRADEMARK, 9-6700 TYPE IV, PER 9-7530 OR 9-3856-5, IN APPROXIMATE POSITION SHOWN; DIRECTION OPTIONAL. TRADEMARK MAY BE SOLID AS SHOWN. SIZE TO BE .032 HIGH.
1. PROCESS SPEC:
TEST 9-5272-29,
PROCESS SHEET CONTROL 9-4796-2,
9-6700, 9-7530, 9-3856-5.

COMPANY ID: 9
CODED/MS/CUST: N
INTERNAL: N
LOTNO: N
DATE CODE: N
SEE PRINT: Y

UNLESS OTHERWISE SPECIFIED
LINEAR DIMENSIONS ARE IN
INCHES.
TOLERANCES: .XXX±.010,
.XX ±.03, .X ±.1,
ANGLES ±2°.
OTHER STANDARDS PER 9-3800
AND DOD-D-1000.
NOTE REF. =

FIND NO.	QTY REQD.	FSCM NO.	PART NUMBER	DESCRIPTION	NOTE REF.
8	1		21-33855-80	INSTALLATION INSTRUCTIONS	3,5
7	1		21-33347-805	CONTACT, OUTER	
6	1		21-33346-805	CONTACT, INTERMEDIATE	
5	1		21-33344-55	CONTACT, INNER	
4	1		21-1381-80	INSULATOR, SUPPORT	
3	1		21-33903-815	FERRULE, INTERMEDIATE	7
2	1		21-33903-805	FERRULE, OUTER	7
1	1		21-33321-9	PIGGYBACK GROMMET SEAL	

SPECIFICATIONS		SIGNATURES		DATES		AMPHENOL CORPORATION 40-60 DELAWARE AVENUE SIDNEY, N.Y.	
MATERIAL SPEC.	N/A	PREPARED	HEMMER	10-22-90			
		CHECKED	HEMMER/PTCH/FOZ	6/26/91			
		MATERIAL	DAVIS	6/26/91			
PROCESS SPEC.	SEE NOTE 1	APPROVED	VAL HEMMER	11-2-90			
		APPROVED	Al Davis	6-27-91			
		1ST PART NO.					
			21-033198-010				

NOTES:
THE USE OF THIS DOCUMENT IS UNLIMITED.
HOWEVER, DOCUMENTS REFERENCED HEREON
MAY CONTAIN LIMITED RIGHTS DATA.

N/A
N/A
NEXT ASSEMBLY

SIZE C 77820
SCALE 10/1
FSCM NO. 21-33198-10
WT.
REF 21-33198-4
SHEET 1 OF 2
REV. C

4

3

2

1

D

D

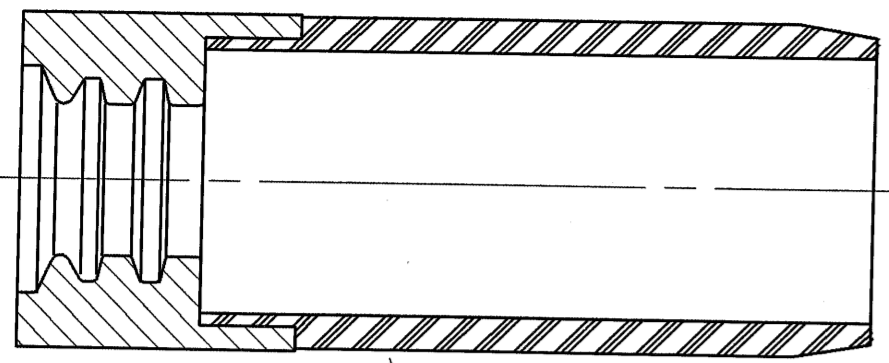

1

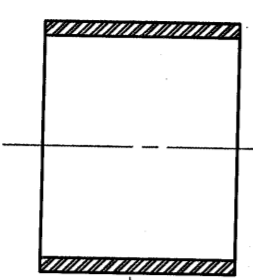

2

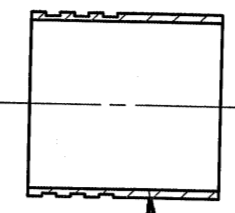

3

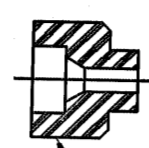

4

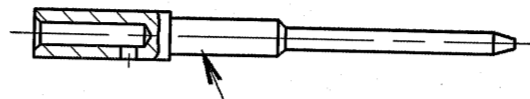

5

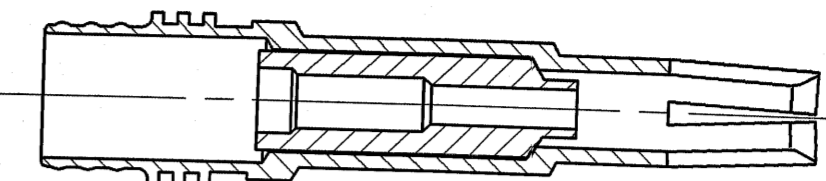

6

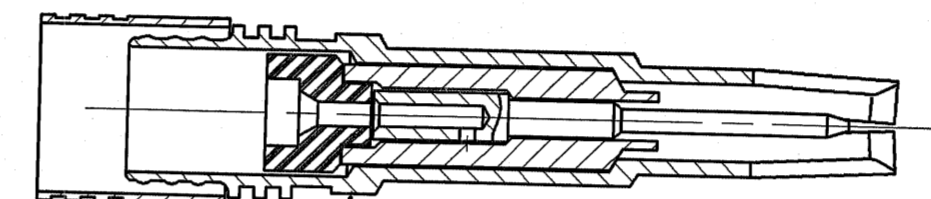

3 4 5 6

REF
ILLUSTRATES
POSITION OF
COMPONENTS
AFTER USER ASSEMBLY

7

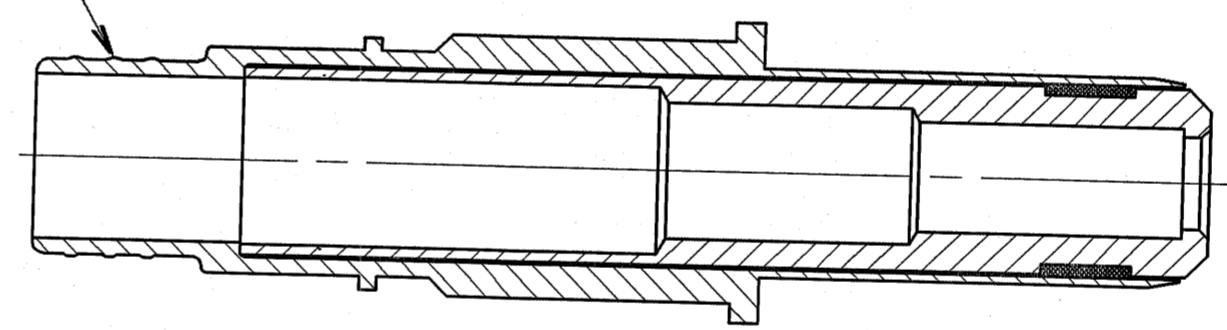

C

C

B

B

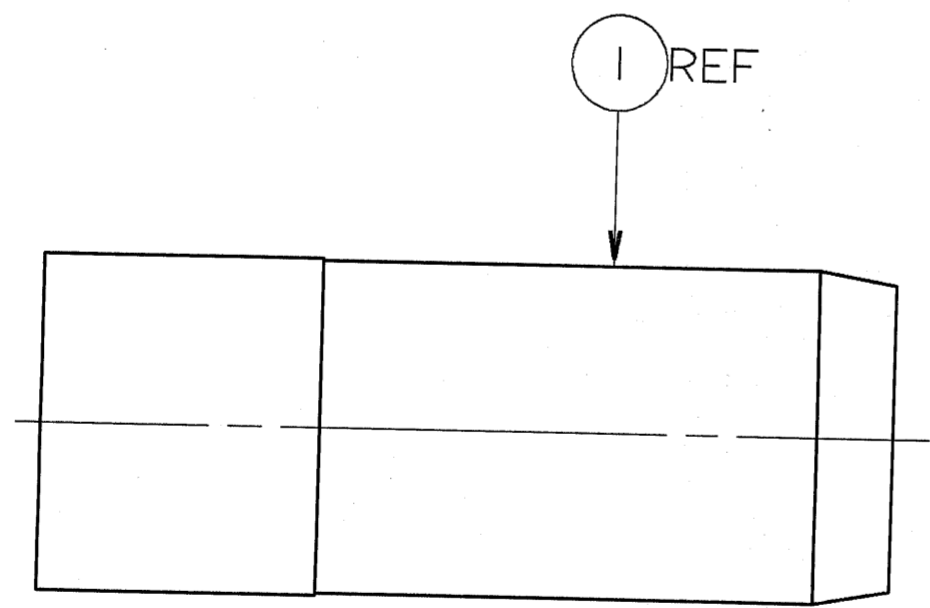

1 REF

2 REF

7 REF

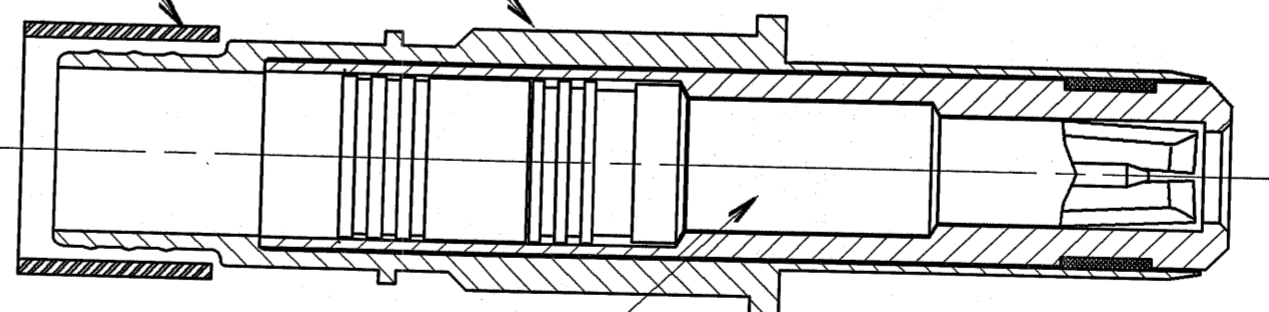

3 4 5 6

REFERENCE:
ILLUSTRATES POSITION
WHEN ASSEMBLED BY USER

A

A

NOTES:

THIS DOCUMENT CONTAINS PROPRIETARY INFORMATION AND SUCH INFORMATION MAY NOT BE DISCLOSED TO OTHERS FOR ANY PURPOSE OR USED FOR MANUFACTURING PURPOSES WITHOUT WRITTEN PERMISSION FROM THE AMPHENOL CORPORATION.

COMPUTER GENERATED DRAWING
IMAGED / May-12-2011, 2:17:35 PM

SIZE	FSCM NO.	REV.
C	77820	C
SCALE	WT.	REF
NONE		N/A
SHEET		
2		

21-33198-10