

REV. A	SHEET 1 OF 1	21-033448-06HF
REVISIONS		
LTR	DESCRIPTION	DATE
A	INITIAL RELEASE	

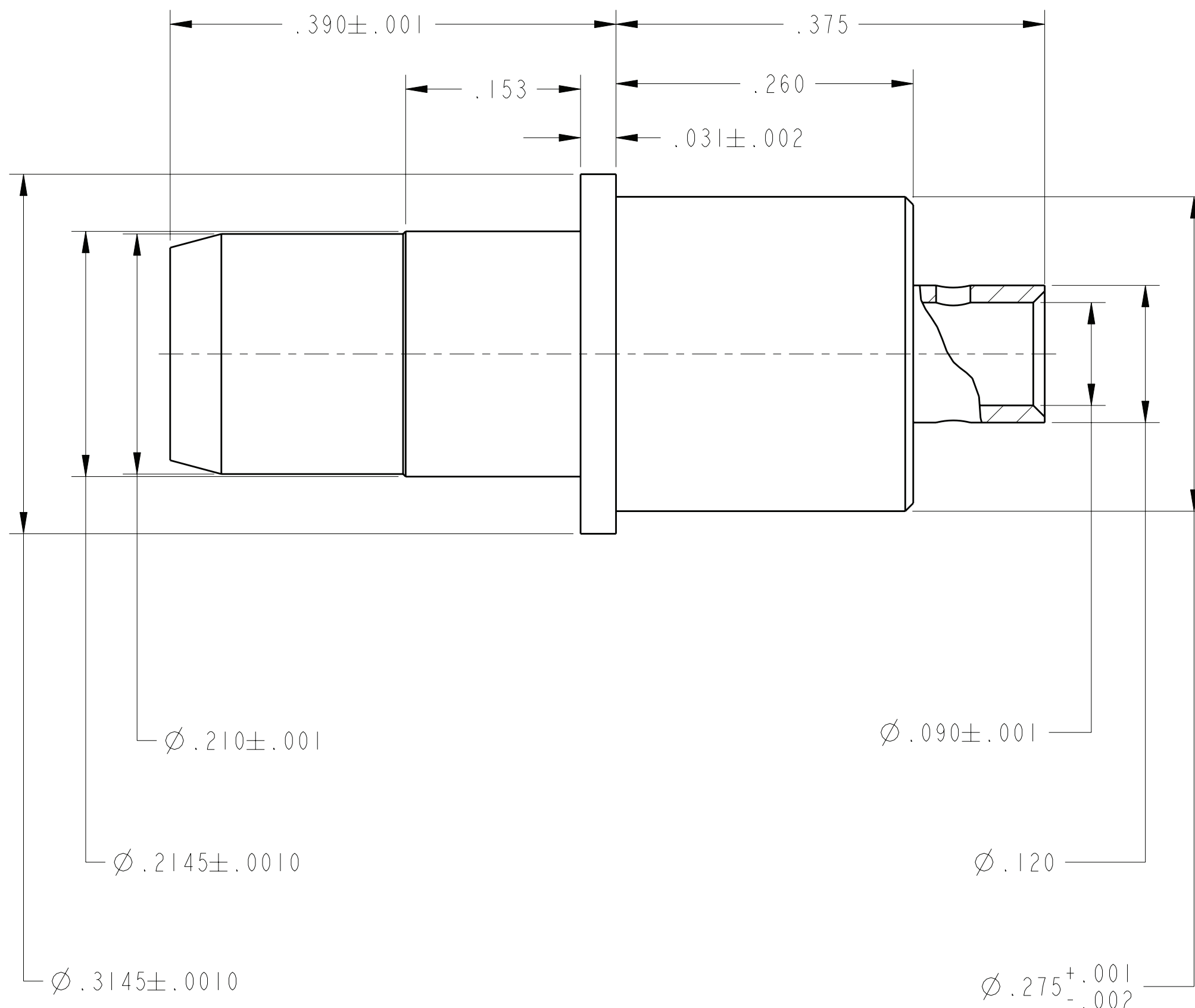

2. WHEN USED IN AN MIL-DTL-38999 CONNECTOR, THIS CONTACT INCORPORATES PIGGYBACK GROMMET SEAL 21-33321-7. ASSEMBLE SEAL OVER CABLE JACKET, RUBBER END FIRST, BEFORE STRIPPING THE CABLE. AFTER INSERTING THE TERMINATED CONTACT INTO THE CONNECTOR INSERT CAVITY, SLIDE THE SEAL INTO THE CONNECTOR GROMMET OPENING. SEAL MUST BE PURCHASED SEPARATELY.

- 1. MATERIAL:
  - BODY: STAINLESS STEEL PER AMS 5640, ALLOY UNS S30300, TYPE 1
  - CONTACT: BERYLLIUM COPPER PER ASTM B196, ALLOY NO. UNS C17300, TD04
  - INSULATOR: PTFE PER ASTM D1710, TYPE 1, GRADE 1, CLASS B
  - FINISH:
  - BODY & CONTACT: GOLD PER ASTM B488, TYPE II, CODE C, CLASS .76; OVER NICKEL PER AMS-QQ-N-290, CLASS 1, .00005" MIN.

PERFORMANCE:  
 IMPEDANCE: 50 OHMS  
 FREQ. RANGE: DC TO 26.5 GHZ  
 VSWR: 1.30:1 MAX. MATED PAIR DC TO 26.5 GHZ  
 INSERTION LOSS: .06 X SQRT(F(F IN GHZ))  
 DWV: 1000 VRMS  
 INSUL. RES. 5000 MEGOHMS MIN  
 OPERATING TEMP: -55°C TO +125°C

NOTES:

THE USE OF THIS DOCUMENT IS UNLIMITED. HOWEVER, DOCUMENTS REFERENCED HEREON MAY CONTAIN LIMITED RIGHTS DATA.

N/A  
 NEXT ASSEMBLY

PRO/ENGINEER INFORMATION  
 Pro/e Model Used:  
 21-033448\_DUMMY-6-7.PART  
 Drawing Name:  
 21-033448-06HF

UNLESS OTHERWISE SPECIFIED	SPECIFICATIONS
LINEAR DIMENSIONS ARE IN INCHES TOLERANCES: .XXXX = ±.0005 ANGLES= ±2° .XXX = ±.010 .XX = ±.03 .X = ±.1	MATERIAL SPEC. N/A
DIM. & TOL. PER ASME Y14.5M; DRM PER MIL-DTL-31000; OTHER Amphenol Stds. PER 9-3800	PROCESS SPEC. N/A
LEGENDS: = FLAG NOTE CALL OUT REFERENCE ONLY	

I	I	21-033448-06M	CONTACT ASSEMBLY	
POS	QTY	PART NUMBER	DESCRIPTION	NOTE
PARTS LIST				
<b>AMPHENOL CORPORATION</b> 40-60 DELAWARE AVENUE SIDNEY, N.Y. 13858 <b>26.5 GHZ BMA PIN,          FOR TFLEX-405 CABLE,          FOR M38999 SIZE 8 CAVITY</b>				
APPROVALS	DATE			
PREPARED BY LRATCHFORD				
ENGINEER IN CHARGE LRATCHFORD	01-Feb-11			
DESIGN MANAGER SHEPLER				
DESIGN ACTIVITY GROUP MIL-AERO-DEVELOP				
THIRD ANGLE PROJECTION				
SIZE C	CAGE CODE 77820	DOCUMENT NO. 21-033448-06HF	REV. A	
SCALE: 4.0	REF. 21-033448-05HF	SHEET 1 OF 1		

21-033448-06HF

SHEET 1 OF 1

REV. A

C

B

A

FORMAT: C-0-E-1

21-033448-06HF

SHEET 1 OF 1

REV. A

VERSION 0

REVISION A

RELEASE STATE WIP

REV. A

SHEET 1 OF 1

21-033448-06HF