

REV. B		SHEET 1 OF 1		DOCUMENT NO. 21-033451-051	
REVISIONS					
LTR	DESCRIPTION			DATE	
A	INITIAL RELEASE			3/22/2012	
B	(CL 1) SEE ECN B4496			---	

21-033451-051

SHEET 1 OF 1

REV. B

C

B

A

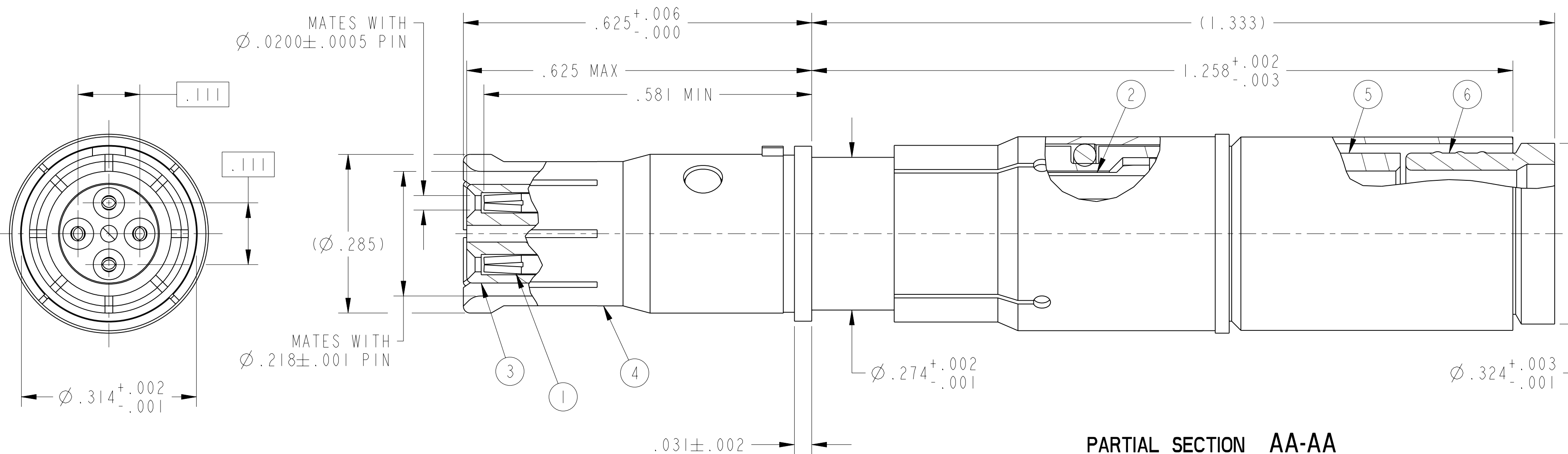

PARTIAL SECTION AA-AA

- 7. MATES WITH D38999 QUADRAX PINS 21-033450-( ).
- 6. CRIMPING TOOLS:  
 OUTER CONTACT- M22520/5-01 TOOL, DANIELS Y2039 DIE SET  
 INNER CONTACTS- M22520/2-01 TOOL, DANIELS K1777 POSITIONER
- 5. TERMINATES QUADRAX CABLE HARBOUR DATA MASTER Q150-24(19)SS (150 OHM) OR EQUIVALENT.
- 4. DRAWING ILLUSTRATES FINAL ASSEMBLY. CONTACT COMPONENTS ARE SHIPPED UNASSEMBLED. INSTALLATION INSTRUCTIONS AND HEATSHRINK (NOT ILLUSTRATED) ARE PACKAGED WITH EACH ASSEMBLY. PACKAGE PER PRODUCTION PROCESS SHEET.
- 3. MATERIALS:  
 OUTER & INNER CONTACTS- BERYLLIUM COPPER PER ASTM-B-196  
 SHIELD FERRULE- BRASS PER ASTM B453 OR QQ-B-626  
 FRONT INSULATOR & SPACER INSULATOR- TFE RESIN PER ASTM 3651
- 2. FINISH:  
 GOLD PLATED PER MIL-G-45204 TYPE II, GRADE C, CLASS I (.000050 MIN)  
 OVER NICKEL PLATE PER QQ-N-290 (.000050 MIN).
- 1. CONTACTS MEET THE ENVELOPE DIMENSIONAL REQUIREMENTS OF M39029/91.

**NOTES:**

THE USE OF THIS DOCUMENT IS UNLIMITED. HOWEVER, DOCUMENTS REFERENCED HEREON MAY CONTAIN LIMITED RIGHTS DATA.

PRO/ENGINEER INFORMATION  
 Pro/e Model Used:  
 21-033451-051.ASSEM  
 Drawing Name:  
 21-033451-051

N/A  
 NEXT ASSEMBLY

UNLESS OTHERWISE SPECIFIED	SPECIFICATIONS
LINEAR DIMENSIONS ARE IN INCHES TOLERANCES: .XXXX = ±.0005 ANGLES= ±2° .XXX = ±.010 .XX = ±.03 .X = ±.1	MATERIAL SPEC. N/A
DIM. & TOL. PER ASME Y14.5M; DRM PER MIL-DTL-31000; OTHER Amphenol Stds. PER 9-3800	PROCESS SPEC. N/A
LEGENDS: = FLAG NOTE CALL OUT REFERENCE ONLY	

POS	QTY	PART NUMBER	DESCRIPTION	NOTE
8	1	L-2119-DV	INSTALLATION INSTRUCTIONS	4
7	1.5"	M23053/8-007-C	HEAT SHRINK	4
6	1	21-033450-056	SHIELD FERRULE	
5	1	21-033450-058	SHIELD EXTENSION	
4	1	21-033451-054	OUTER CONTACT	
3	1	21-033451-053	FRONT INSULATOR	
2	2	21-033450-055	REAR INSULATOR	
1	4	21-033451-052	INNER CONTACT	

APPROVALS

PREPARED BY: J. BORDEAU  
 ENGINEER IN CHARGE: D. PHILLIPS  
 DESIGN MANAGER: E. HICKEY  
 DESIGN ACTIVITY GROUP: CI

DATE: 19-Mar-12

THIRD ANGLE PROJECTION

**PARTS LIST**

**AMPHENOL CORPORATION**  
 40-60 DELAWARE AVENUE  
 SIDNEY, N.Y. 13858

**CONTACT, SOCKET, QUADRAX,  
 ELECTRICAL CONNECTOR,  
 TYPE D38999 I & III**

SIZE: C  
 CAGE CODE: 77820  
 SCALE: 7.0

DOCUMENT NO.: 21-033451-051  
 REF: L-40456-600

REV. B  
 SHEET 1 OF 1

FORMAT: C-U-E-1

21-033451-051 SHEET 1 OF 1 REV. B