

REV	LTR	REVISIONS	
		DESCRIPTION	DATE
B	A	INITIAL RELEASE	---
B	(CL 11) SEE ECN A5333		---

21-33614-21

SHEET 1 OF 2

REV B

C

B

A

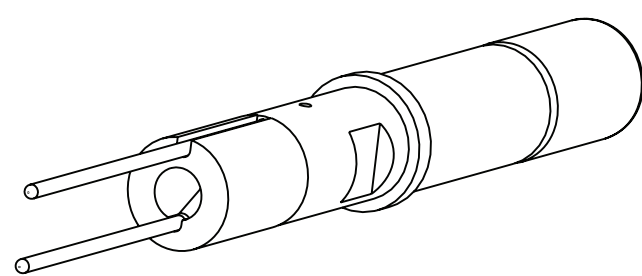

SCALE 4.000

METAL STAKE EACH  
SIDE TO TRAP IN  
F/N 3

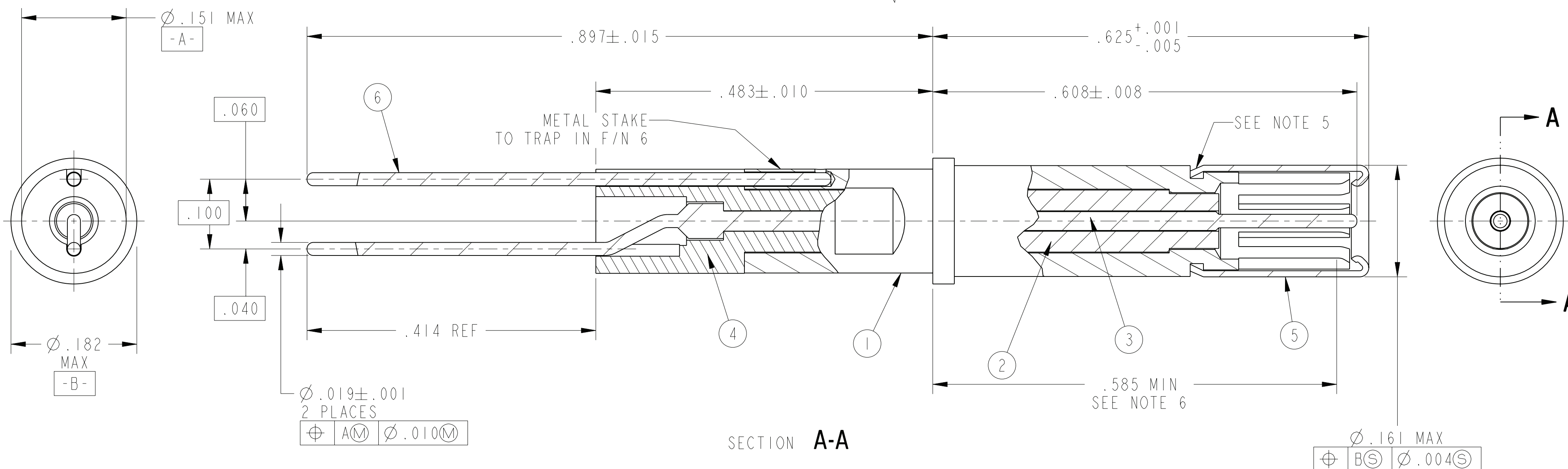

SECTION A-A

NOTES: SEE SHEET 2

THE USE OF THIS DOCUMENT IS UNLIMITED.  
HOWEVER, DOCUMENTS REFERENCED HEREON  
MAY CONTAIN LIMITED RIGHTS DATA.

N/A  
NEXT ASSEMBLY

PRO/ENGINEER INFORMATION  
Pro/e Model Used:  
21-033614-021.ASSEM  
Drawing Name:  
21-33614-21

UNLESS OTHERWISE SPECIFIED

LINEAR DIMENSIONS ARE IN INCHES  
TOLERANCES:  
.XXXX = ±.0005 ANGLES= ±2°  
.XXX = ±.010  
.XX = ±.03  
.X = ±.1

DIM. & TOL. PER ASME Y14.5M;  
DRM PER MIL-DTL-31000;  
OTHER Amphenol Stds. PER 9-3800  
LEGENDS:  
= FLAG NOTE CALL OUT  
REFERENCE ONLY

SPECIFICATIONS

MATERIAL SPEC.  
N/A

PROCESS SPEC.  
N/A

POS	QTY	PART NUMBER	DESCRIPTION	NOTE
6	1	21-33614-25	PCB TAIL	
5	1	10-407914-12B	SLEEVE	
4	1	21-33613-4	REAR INSULATOR	
3	1	21-33614-23	INNER CONTACT	
2	1	21-33613-6	FRONT INSULATOR	
1	1	21-33613-2	OUTER CONTACT	

APPROVALS		DATE
PREPARED BY	D. FREAR	07-May-01
ENGINEER IN CHARGE	LRATCHFORD	
DESIGN MANAGER	ADAVIS	
DESIGN ACTIVITY GROUP	MIL-AERO DEVELOP	
THIRD ANGLE PROJECTION		

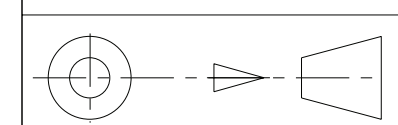

**AMPHENOL CORPORATION**  
40-60 DELAWARE AVENUE  
SIDNEY, N.Y. 13858

**CONTACT, SOCKET, PCB,  
COAXIAL, SIZE 12,  
TYPE LJT**

SIZE <b>C</b>	CAGE CODE <b>77820</b>	DOCUMENT NO. <b>21-33614-21</b>	REV. <b>B</b>
SCALE: 9.0		REF 21-33857-3	SHEET 1 OF 2

D

C

VERSION

REVISION

RELEASE STATE

Released

REV

SHEET 1 OF 2

21-33614-21

FORMAT: C-0-E-1

DOCUMENT NO. 21-33614-21

SHEET 1 OF 2

REV. B

21-33614-21

SHEET 2 OF 2

REV. B

C

B

A

8. AFTER ASSEMBLY, THE OUTER SURFACE OF THE SOCKET TINES MUST NOT BE VISIBLE THROUGH THE OPENING OF HOOD WHEN VIEWED AT 20X DOWN THE CENTER AXIS OF THE ASSEMBLY.
7. A .0950+.0002-.0000 DIA HARDENED STEEL PIN MUST ENGAGE SOCKET WITH A FORCE NOT GREATER THAN 30 OUNCES. FOLLOWING THIS A .0930+.0000-.0002 DIA HARDENED STEEL PIN MUST DISENGAGE SOCKET WITH A FORCE NOT LESS THAN 4 OUNCES. PINS TO HAVE A SPHERICAL TIP, A  $\sqrt{3}$  FINISH AND ENGAGE .114 MIN. NOTE APPLIES AFTER SLEEVE ASSEMBLY.
6. INDICATED DIMENSION TO BE FROM REAR OF SOCKET SHOULDER TO POINT OF ENGAGEMENT OF CONTACT AND A .0940±.0002 DIA SQUARE ENDED PIN.
5. CRIMP SLEEVE TIGHTLY TO OUTER CONTACT.
4. DIELECTRIC WITHSTANDING VOLTAGE TEST:  
  
CONTACT ASSEMBLY SHALL MEET THE FOLLOWING REQUIREMENTS AFTER ASSEMBLY HAS BEEN COMPLETED.
  - A. A TEST VOLTAGE OF 500 VOLTS AC RMS SHALL BE APPLIED BETWEEN THE INNER AND OUTER CONTACTS.
  - B. THE VOLTAGE SHALL BE APPLIED FR 2 SECONDS MINIMUM.
  - C. THE LEAKAGE CURRENT SHALL NOT EXCEED 1 MILLAMPERE.
  - D. THERE SHALL BE NO EVIDENCE OF BREAKDOWN OR FLASHOVER.
3. PACKAGE PER PRODUCTION SHEET.  
HANDLE CAREFULLY TO AVOID DISTORTION OF PCB TAILS.
2. CLEANING OF PARTS IN CHLORINATED SOLVENTS IS NOT PERMISSIBLE.
1. MATES WITH COAXIAL PIN CONTACT SERIES 21-33122-54().

**NOTES:**

THE USE OF THIS DOCUMENT IS UNLIMITED. HOWEVER, DOCUMENTS REFERENCED HEREON MAY CONTAIN LIMITED RIGHTS DATA.

DOCUMENT NO. <b>21-33614-21</b>	SHEET 2 OF 2	REV. <b>B</b>
------------------------------------	--------------	------------------

SIZE <b>C</b>	CAGE CODE <b>77820</b>	DOCUMENT NO. <b>21-33614-21</b>	REV. <b>B</b>
SCALE: 10.0		REF: 21-33857-3	SHEET 2 OF 2

RELEASE STATE  
**Released**

REVISION  
**B**

VERSION  
**I**

SHEET 2 OF 2

21-33614-21