

REV. B	SHEET 1 OF 2	DOCUMENT NO. 21-33840-1
REVISIONS		
LTR	DESCRIPTION	DATE
A	INITIAL RELEASE	1/09/03
B	(CL 1) SEE CHG NOTICE ECN: B1261-0000	10/28/11

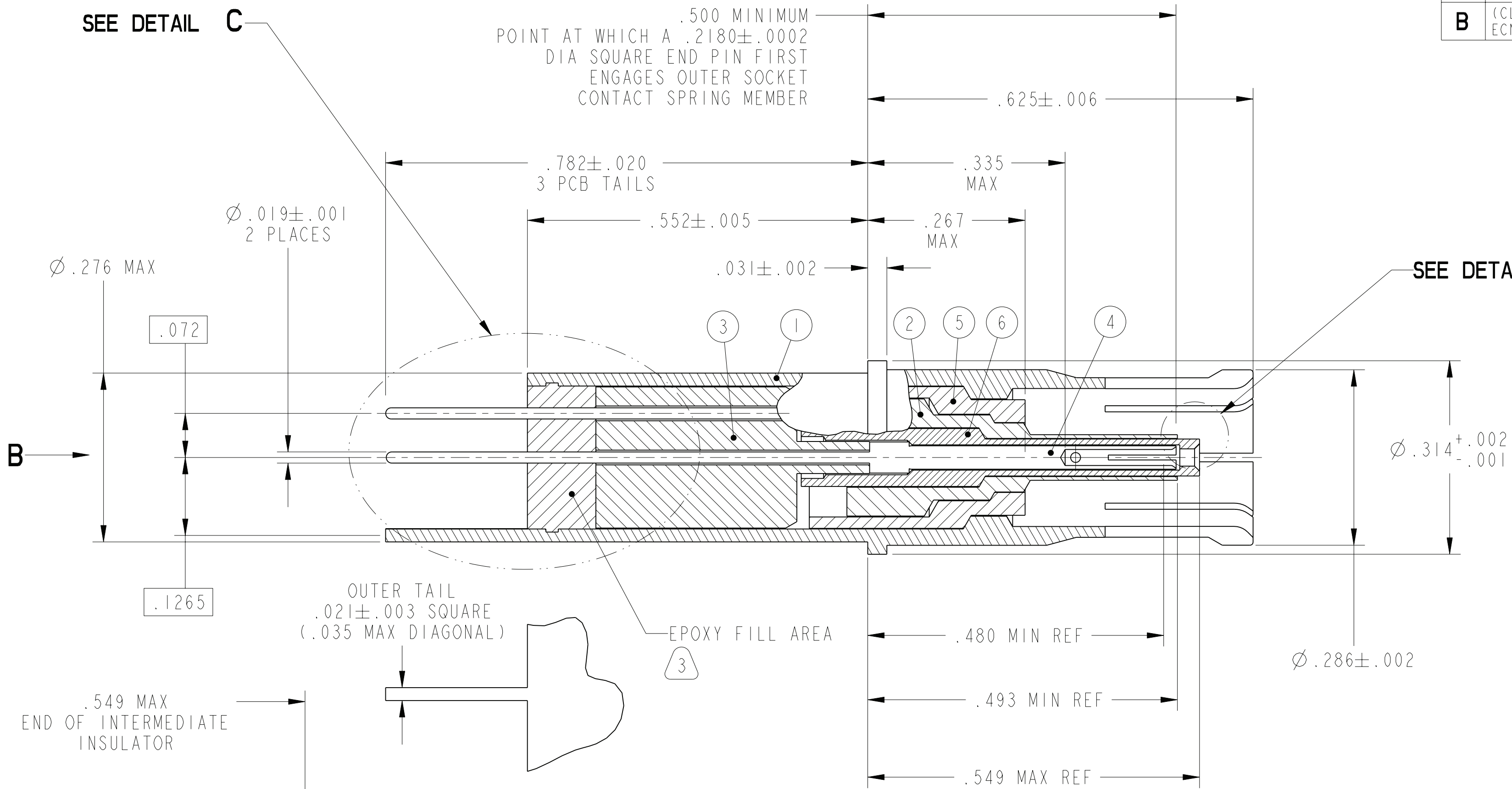

OUTER SOCKET CONTACT:
MATES WITH A
.218±.001 DIA
PIN CONTACT

INTERMEDIATE PIN CONTACT:
.074±.001 DIA

INNER SOCKET CONTACT:
MATES WITH A
.0240±.0005
DIA PIN CONTACT

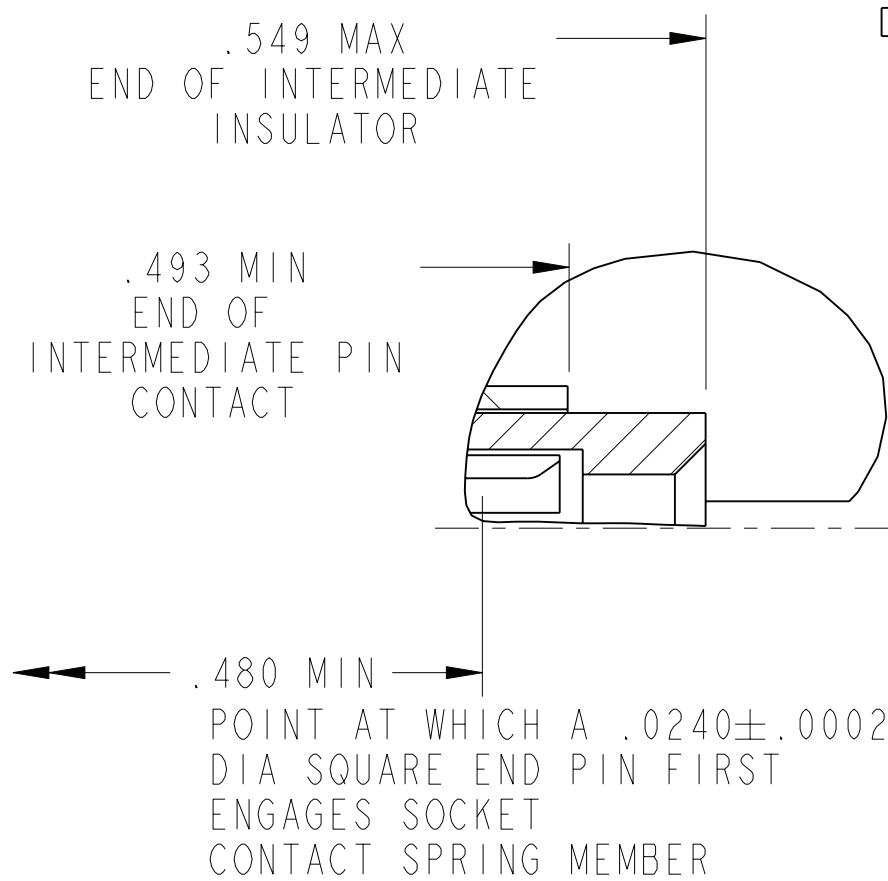

DETAIL A
SCALE 20

NOTES: SEE SHEET 2

THE USE OF THIS DOCUMENT IS UNLIMITED. HOWEVER, DOCUMENTS REFERENCED HEREON MAY CONTAIN LIMITED RIGHTS DATA.

N/A
NEXT ASSEMBLY

PRO/ENGINEER INFORMATION
Pro/e Model Used:
21-033840-001.ASSEM
Drawing Name:
21-33840-1

UNLESS OTHERWISE SPECIFIED
SPECIFICATIONS

LINEAR DIMENSIONS ARE IN INCHES
TOLERANCES:
.XXXX = ±.0005 ANGLES= ±2°
.XXX = ±.010
.XX = ±.03
.X = ±.1

DIM. & TOL. PER ASME Y14.5M;
DRM PER MIL-DTL-31000;
OTHER Amphenol Stds. PER 9-3800

LEGENDS:
= FLAG NOTE CALL OUT REFERENCE ONLY

MATERIAL SPEC. N/A

PROCESS SPEC. SEE NOTE 6

POS	QTY	PART NUMBER	DESCRIPTION	NOTE
6	1	21-033853-001	INSULATOR, INNER	
5	1	21-033850-001	INSULATOR, OUTER	
4	1	21-033840-003	SOCKET CONTACT, INNER	1
3	1	21-033840-006	REAR CAP	7
2	1	21-033840-004	PIN CONTACT, INTERMEDIATE	1
1	1	21-033840-002	SOCKET CONTACT, OUTER	1

APPROVALS		DATE
PREPARED BY	J. HEATH	
ENGINEER IN CHARGE	L. RATCHFORD	02-Dec-02
DESIGN MANAGER	A. DAVIS	
DESIGN ACTIVITY GROUP	MIL AERO	

AMPHENOL CORPORATION
40-60 DELAWARE AVENUE
SIDNEY, N.Y. 13858

**CONTACT, SOCKET, TRIAXIAL, PCB,
TYPE LJT-R & TV-R, SIZE 8**

SIZE C	CAGE CODE 77820	DOCUMENT NO. 21-33840-1	REV. B
SCALE: 7.0	REF 21-33841-1	SHEET 1 OF 2	

DOCUMENT NO. 21-33840-1
SHEET 1 OF 2
REV. B

VERSION 0
REVISION B
Eng. PDM Information For Reference Only
SHEET 1 OF 2
REV. B
DOCUMENT NO. 21-33840-1

21-33840-1
SHEET 2 OF 2
REV. B

EPOXY FILL AREA

3

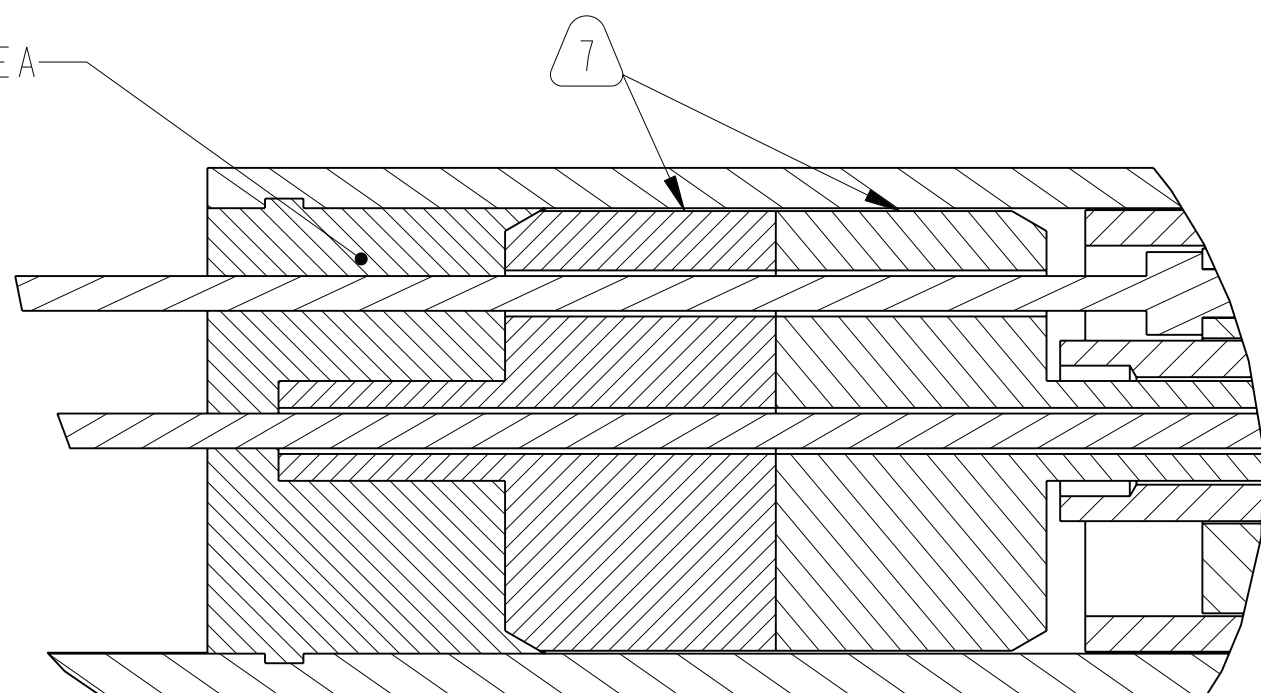

**ALTERNATE ASSEMBLY
DETAIL C**
SCALE 10

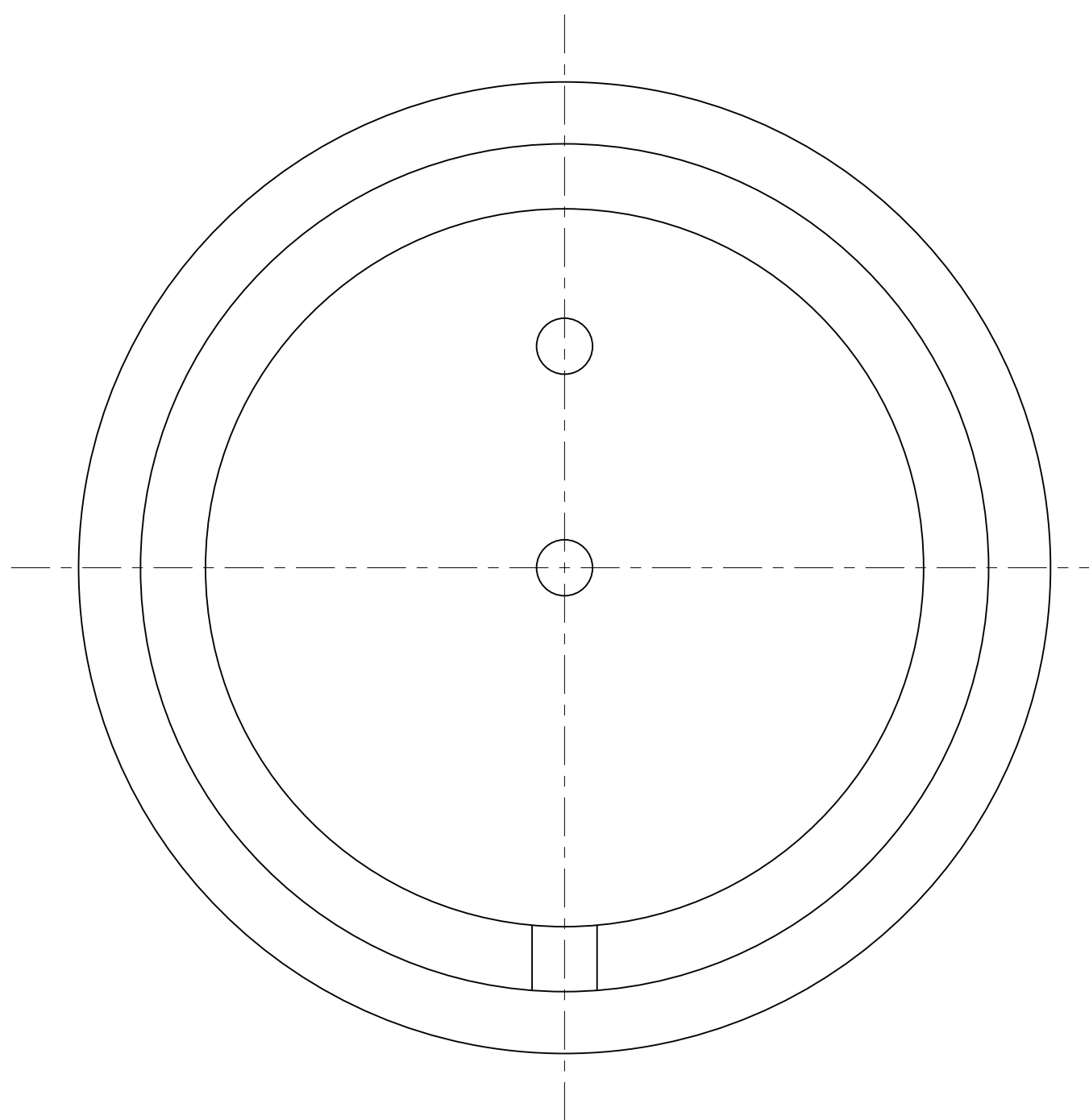

VIEW AT B
SCALE 20

7. REAR CAP INSULATOR 21-33847-1 (2 PCS) MAY BE USED IN LIEU OF REAR CAP INSULATOR 21-33840-6 (SEE ALTERNATE ASSEMBLY VIEW).
6. PROCESS SPEC:
TEST 9-5272-29
9-6700, 9-7530, 9-3856-5, 9-4954-5
5. BLACK INK STAMP TRADEMARK 9-6700 TYPE IV PER 9-7530 OR 9-3856-5 ON OUTER CONTACT. TRADEMARK MAY BE SOLID AND DIRECTION IS OPTIONAL.
4. DRAWING ILLUSTRATES FINAL ASSEMBLY, PACKAGE PER PRODUCTION PROCESS SHEETS.
3. EPOXY FILL INDICATED AREA WITH EPOXY 9-4954-5 TO HOLD INNER COMPONENTS IN PLACE. NO EPOXY PERMITTED ABOVE OUTER SURFACE OF CONTACT ASSEMBLY. CURE EPOXY AT 250°F FOR 3 HOURS.
2. FINISH ON ALL METAL COMPONENTS:
.000050 MIN GOLD (KNOOP HARDNESS 130-200).
1. ORIENTATION OF PCB TAILS MUST BE AS ILLUSTRATED.

NOTES:

THE USE OF THIS DOCUMENT IS UNLIMITED. HOWEVER, DOCUMENTS REFERENCED HEREON MAY CONTAIN LIMITED RIGHTS DATA.

FORMAT: C-0-E-1

21-33840-1

SHEET 2 OF 2

REV. B

SIZE C	CAGE CODE 77820	DOCUMENT NO. 21-33840-1	REV. B
SCALE: 7.0		REF: 21-33841-1	SHEET 2 OF 2

21-33840-1
SHEET 2 OF 2
REV. B
Eng PDM Information For Reference Only
REVISION B
VERSION 0