

REV. PA3	SHEET 1 OF 3	DOCUMENT NO. RS2-PST-XXXX
REVISIONS		
LTR	DESCRIPTION	DATE
PA3	ADDED CENTER MT. & -250( )	11/30/15

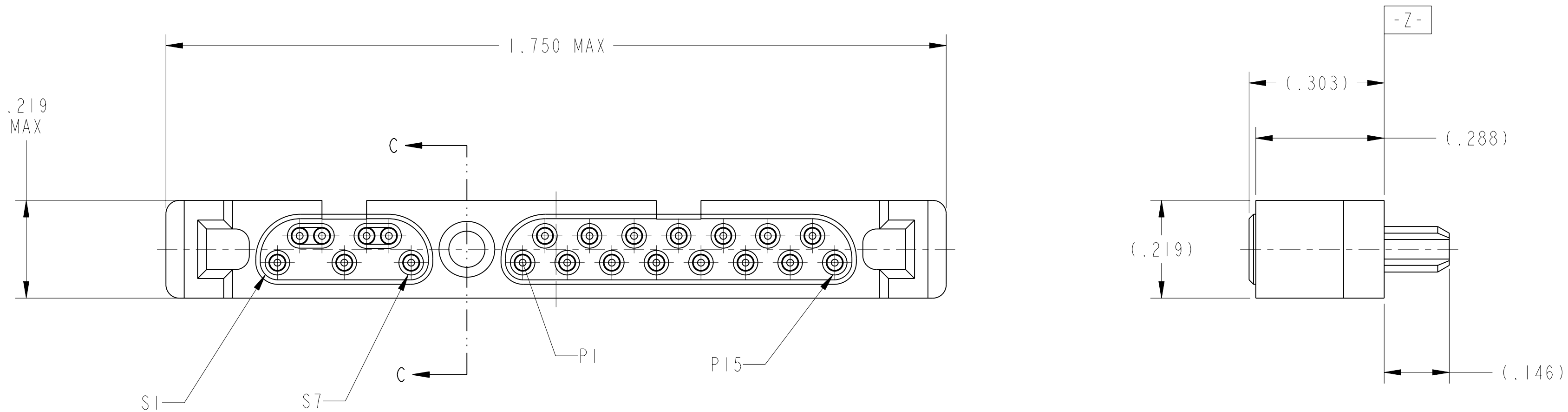
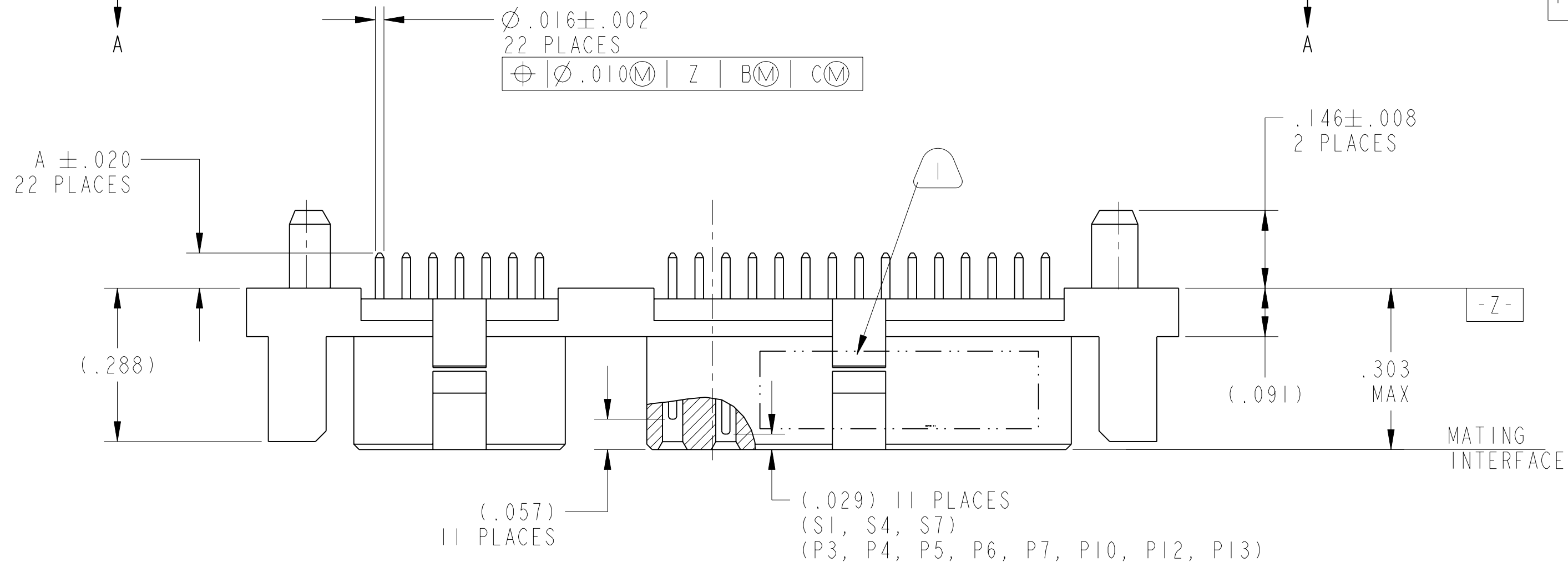

SEE SHEET 2

NOTES:

THE USE OF THIS DOCUMENT IS UNLIMITED. HOWEVER, DOCUMENTS REFERENCED HEREON MAY CONTAIN LIMITED RIGHTS DATA.

SCALE 5.000

N/A	PRO/ENGINEER INFORMATION
N/A	Pro/e Model Used: RS2-PST22-070X.ASSEM
NEXT ASSEMBLY	Drawing Name: RS2-PST22-XXXX

UNLESS OTHERWISE SPECIFIED		SPECIFICATIONS	POS	QTY	PART NUMBER	DESCRIPTION	NOTE
LINEAR DIMENSIONS ARE IN INCHES TOLERANCES: .XXXX = ±.0005 ANGLES= ±2° .XXX = ±.010 .XX = ±.03 .X = ±.1		MATERIAL SPEC. NA	APPROVALS		DATE	PARTS LIST	
DIM. & TOL. PER ASME Y14.5M; DRM PER MIL-DTL-31000; OTHER Amphenol Sds. PER 9-3800		PROCESS SPEC. 9-3856-5 9-3895	PREPARED BY R. CHAPMAN	ENGINEER IN CHARGE J. PAUL	18-May-15	AMPHENOL CORPORATION 40-60 DELAWARE AVENUE SIDNEY, N.Y. 13838	
LEGENDS: =FLAG NOTE CALL OUT REFERENCE ONLY			DESIGN MANAGER R. SELFRIDGE	DESIGN ACTIVITY GROUP BLP		CONNECTOR, ELECTRICAL, PLUG, R-SATA, 22 POSITION (PCB TERMINATION)	
			THIRD ANGLE PROJECTION			SIZE C	CAGE CODE 77820
						DOCUMENT NO. RS2-PST-XXXX	REV. PA3
						SCALE: 2.0	REF: NONE
						SHEET 1 OF 3	

PART NUMBER	"A" STICKOUT
RS2-PST22-070( )	.070
RS2-PST22-090( )	.090
RS2-PST22-110( )	.110
RS2-PST22-130( )	.130
RS2-PST22-250( )	.250

TERMINATION FINISH  
(SEE SUFFIX TABLE)

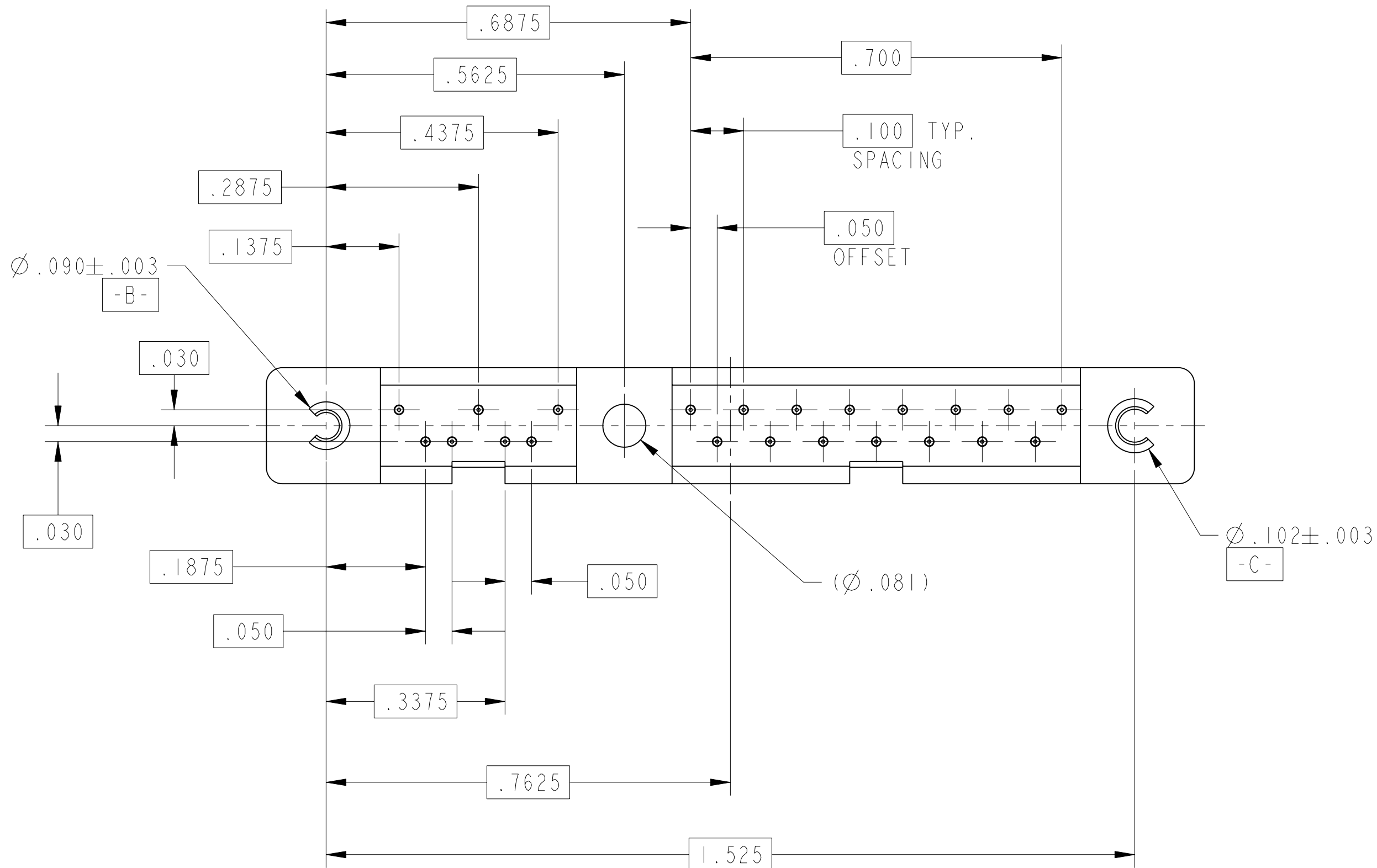

VIEW AT A

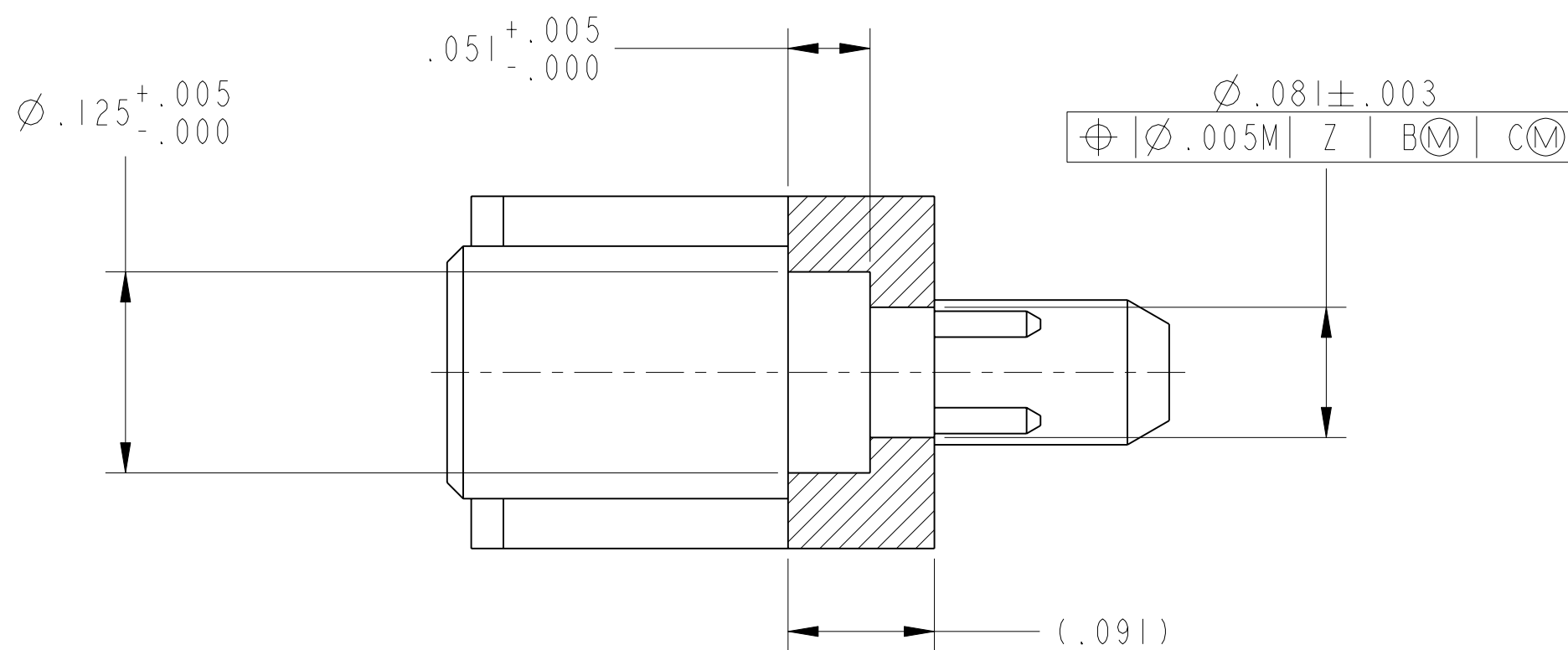

SECTION C-C

SCALE 10.000

TERMINATION SUFFIX TABLE	
SUFFIX	DESCRIPTION
2	GOLD PLATE, .000050 MIN. THICK GOLD OVER .000050 MIN. THICK NICKEL.
6	TIN-LEAD SOLDER DIPPED OVER SUFFIX 1 .0010 MIN THICK TIN-LEAD (Sn63%)

- SEE SHEET 3 FOR SUGGESTED CIRCUIT BOARD LAYOUT.
- FOR MATING PLUG CONNECTOR SEE DRAWING RS2-RST22-( ) AND OTHERS.
- INK STAMP IN CONTRASTING COLOR "AMPHENOL" 77820 PART NUMBER AND DATE CODE ON INDICATED SURFACE (MAY BE ON BOTH SIDES) PER 9-3856-5. DATE CODE PER 9-3895. CHARACTERS TO BE .062±.020 HIGH. ADDITIONAL INFORMATION MAY BE REQUESTED ON PURCHASE ORDER.  
EXAMPLE: AMPHENOL 77820 RS2-PST22-0701 1515

THE USE OF THIS DOCUMENT IS UNLIMITED.  
HOWEVER, DOCUMENTS REFERENCED HEREON  
MAY CONTAIN LIMITED RIGHTS DATA.

SIZE <b>C</b>	CAGE CODE <b>77820</b>	DOCUMENT NO. <b>RS2-PST-XXXX</b>	REV. <b>PA3</b>
SCALE: 2.0	REF.	NONE	SHEET 2 OF 3

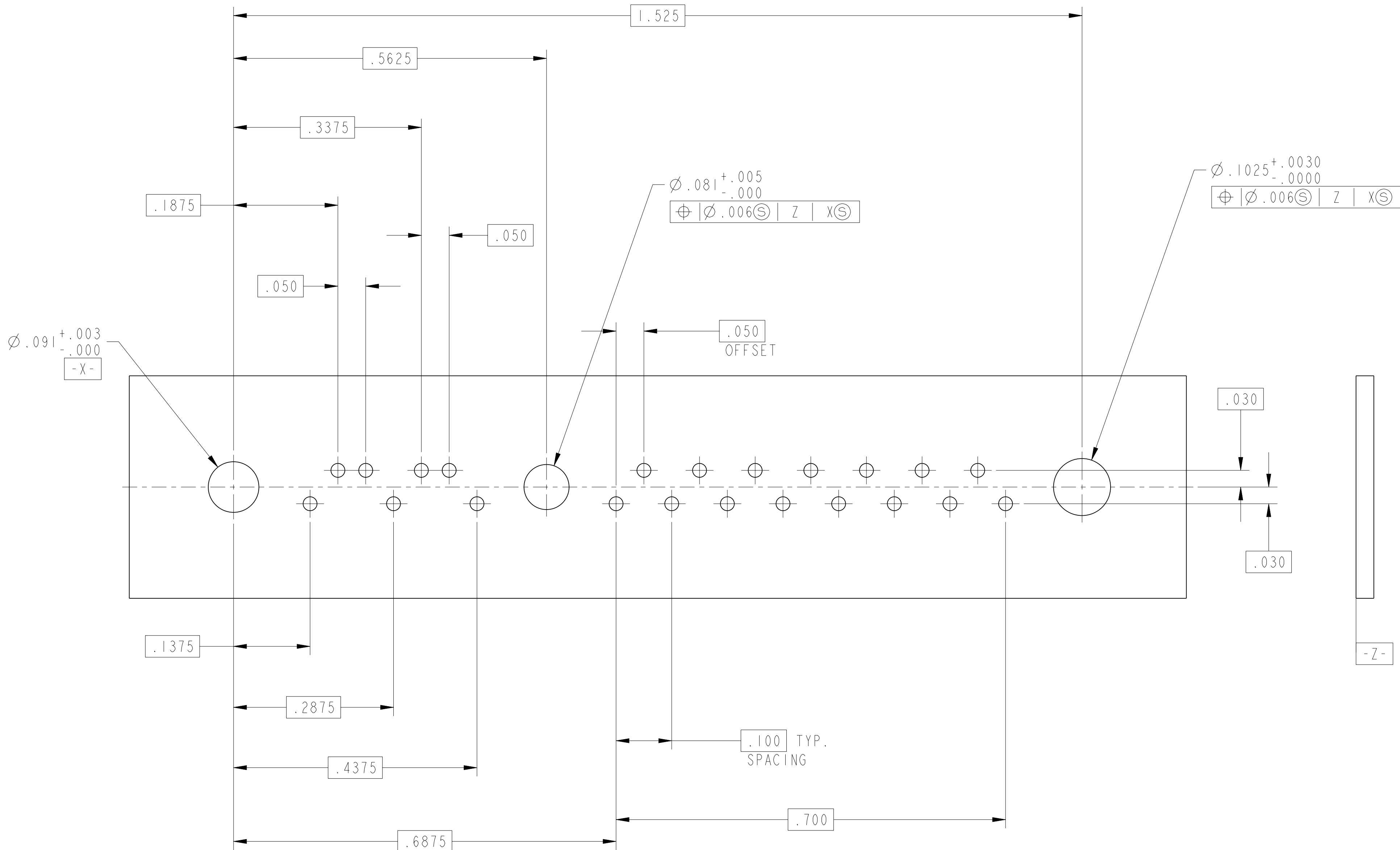

**SUGGESTED PRINTED CIRCUIT BOARD LAYOUT**

SCALE 8.000

THE USE OF THIS DOCUMENT IS UNLIMITED. HOWEVER, DOCUMENTS REFERENCED HEREON MAY CONTAIN LIMITED RIGHTS DATA.

SIZE <b>C</b>	CAGE CODE <b>77820</b>	DOCUMENT NO. <b>RS2-PST-XXXX</b>	REV. <b>PA3</b>
SCALE: 2.0	REF: NONE	SHEET 3 OF 3	